

MERIDIEN

INS-VS1

ALL MEASUREMENTS ARE IN MILLIMETRES

MANUFACTURED FROM STAINLESS STEEL

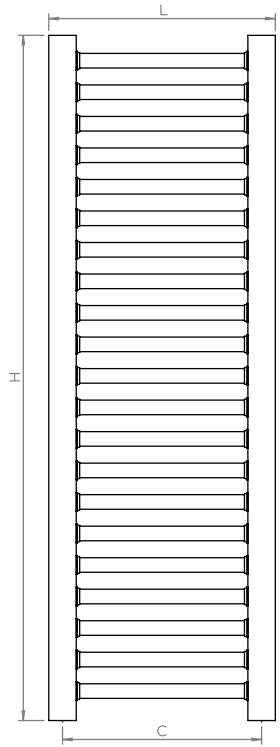
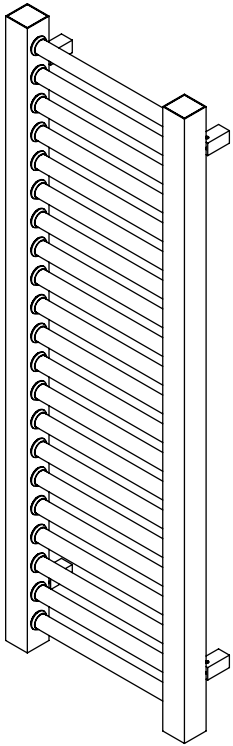

Front View

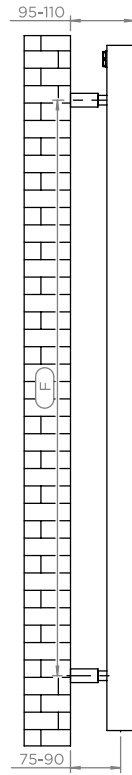

Side View

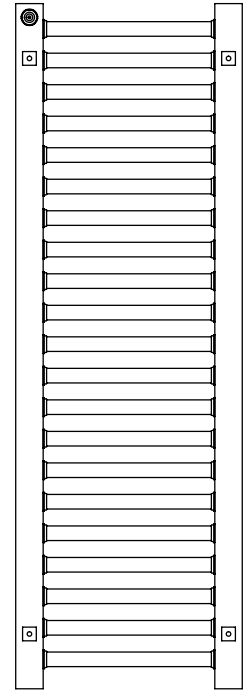

Back View

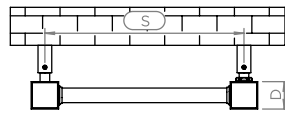

Top View

Installation Accessories:

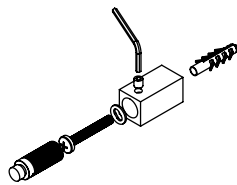
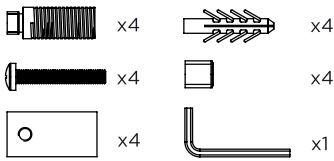

Vertical mount
 All Dimensions are in mm
 Max. Working Pressure: 10 Bar
 Max. Working Temperature: 95° C
 Inlet / Outlet : 1/2" BSP
 Fuel : E/H/D

Manufacturing Tolerance : - 5 mm

PRODUCT CODE	Height		Length		Depth	Pipe Centres		Bracket Centres	
	H	mm	L	mm	D	C	F	S	mm
MER100	1000		330		40	290		840	290
MER150	1500		330		40	290		1340	290
MER180	1800		330		40	290		1640	290
MER200	2000		330		40	290		1840	290

Plumbing Position:

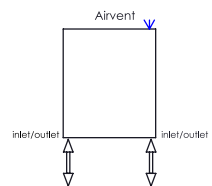

Technical specifications are subject to change without prior notice.

AEON is the designer heating division of Pitacs Limited.
 Pitacs Limited, Bradbourne Point, Bradbourne Drive, Tilbrook, Milton Keynes,
 Buckinghamshire, MK7 8AT, UK

T: +44 (0)1908 271155 E: info@pitacs.com W: www.aeon.uk.com

