

# KARE E

INS-VS1

ALL MEASUREMENTS ARE IN MILLIMETRES

MANUFACTURED FROM STAINLESS STEEL

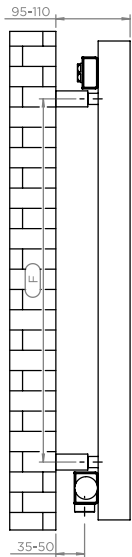
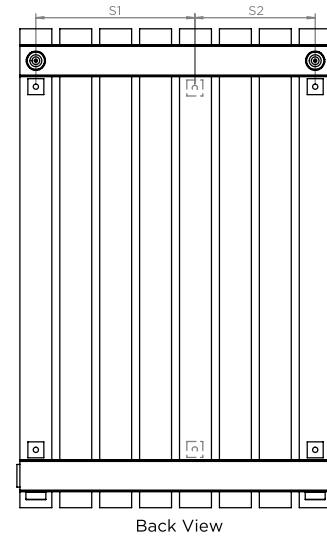
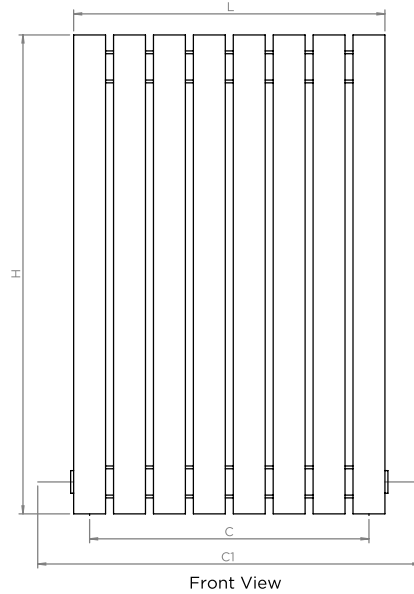
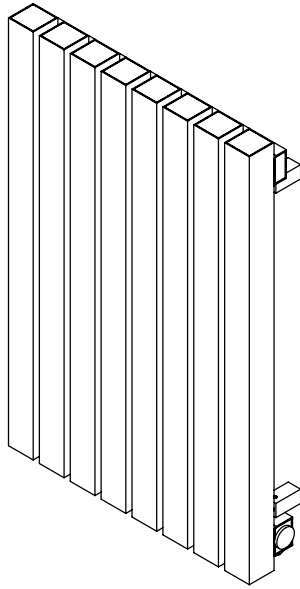

Side View

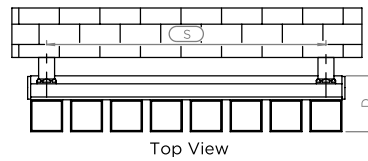

Top View

Installation Accessories:

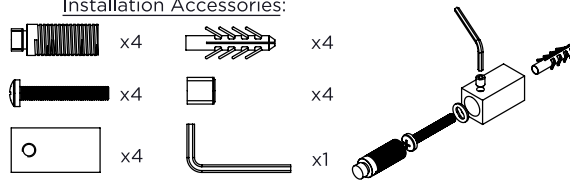

Plumbing Position:

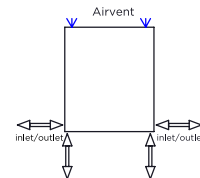

Vertical mount  
All Dimensions are in mm  
Max. Working Pressure: 10 Bar  
Max. Working Temperature: 95° C  
Inlet / Outlet : 1/2" BSP  
Fuel : E/H/D

Note: Dimension (S1,S2) available for minimum 24 profile Manufacturing Tolerance : - 5 mm

PRODUCT CODE	Height		Length	Depth	Pipe Centres		Bracket Centres	
	H	F			C-C1	S (S1-S2)		
	mm	mm	mm	mm	mm	mm	mm	
KRE8-6060	600	390	70	350-380	455	350		
KRE10-6060	600	490	70	450-580	455	450		
KRE12-6060	600	590	70	550-680	455	550		
KRE14-6060	600	690	70	650-780	455	650		
KRE16-6060	600	790	70	750-880	455	750		
KRE20-6060	600	990	70	950-1080	455	950		
KRE24-6060	600	1190	70	1150-1280	455	600-550		
KRE28-6060	600	1390	70	1350-1480	455	700-650		
KRE32-6060	600	1590	70	1550-1680	455	800-750		
KRE36-6060	600	1790	70	1750-1880	455	900-850		

FR,71-Rev,00

Technical specifications are subject to change without prior notice.



AEON is the designer heating division of Pitacs Limited.  
Pitacs Limited, Bradbourne Point, Bradbourne Drive, Tilbrook, Milton Keynes,  
Buckinghamshire, MK7 8AT, UK

T: +44 (0)1908 271155 E: info@pitacs.com W: www.aeon.uk.com