

## TRV 2 WAY RANGE

### INTRODUCTION

The Myson TRV 2-way is the most complete thermostatic radiator valve range available for today's central heating systems.

Incorporating Myson's unique '2-way' engineering, including the Myson patented 'bonding' technique (see diagram). The Myson TRV 2-way simplifies installation and removes the worry of costly callbacks.

The Myson TRV 2-way has a liquid sensor fitted at its heart, so the homeowner will be guaranteed years of accurate and trouble-free temperature control, with the advantage of saving up to 17% on their heating bills (Government figures). As the homeowner saves money, the environment will benefit from the reduction of harmful gas emissions.

The Myson TRV 2-way is available in polished chrome, nickel or brass finish, in pipe sizes up to 22mm or 3/4" BSP. Also in the range is an 8/10/15mm valve, for the installer or supplier who wishes to stock only the one universal valve.

Voted the most popular choice in the independent 'Ricability' report 2004. The Myson TRV 2-way is the only choice for the professional installer, the homeowner, specifier and Local Authorities.



2 TRV 15C



2 TRV 15SC



2 TRV 15N

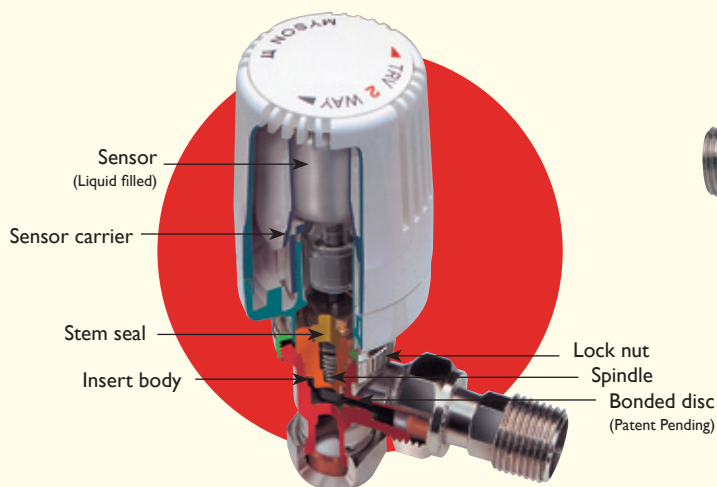

**TRV2WAY**



## TRV 2 WAY RANGE

### SPECIFICATION

Maximum operating pressure	10 BAR						
Maximum water temperature	120°						
Maximum differential pressure	0.6 Bar						
Conforms to	BS EN215-1						
Sensing element	Liquid Filled						
Finish Options	Polished Chrome Satin Brass Nickel						
Hysteresis	<0.5°K						
Setting	○	✱	I	II	III	IIII	●
Temp°C	off	8	12	16	20	24	28
Manufactured to quality system BS.EN ISO 9000:2000							

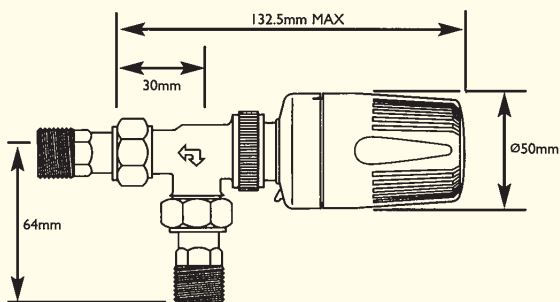

### HOW THE 2-WAY WORKS

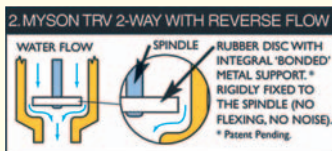
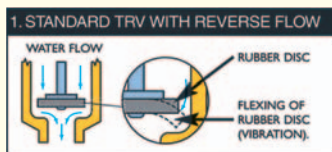

M28 TRV BODY- HEAD ADAPTOR

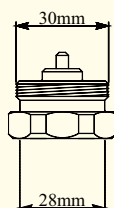

### RANGE

TRV 2-WAY (CEN 215)	BSP THREAD SIZE	PIPE SIZE mm	ORDER CODE
Std Polished Chrome TRV 2-way	—	8	2 TRV 8C
Std Polished Chrome TRV 2-way	—	10	2 TRV 10C
Std Polished Chrome TRV 2-way	—	15	2 TRV 15C
Straight Polished Chrome TRV 2-way	—	15	2 TRV 15SC
Std Satin Brass TRV 2-way	—	8	2 TRV 8B
Std Satin Brass TRV 2-way	—	10	2 TRV 10B
Std Satin Brass TRV 2-way	—	15	2 TRV 15B

#### CONTRACT TRV 2-way (CEN 215)

Std Nickel Finish	—	15	2 TRV 15N
Std Nickel Finish	—	10/15	2 TRV 10N
Std Nickel Finish	—	8/10/15	2 TRV US
Straight Nickel Finish	—	10/15	2 TRV 10NS

#### RADIATOR THERMOSTAT VALVE BODIES (NICKEL FINISH)

Vertical Angle	½"	15	2 TRV 15AN
Vertical Angle	¾"	22	2 TRV 22AN
Horizontal Angle	½"	15	2 TRV 15IN
Horizontal Angle	¾"	22	2 TRV 22IN
Straight	½"	15	2 TRV 15SN
Straight	¾"	22	2 TRV 22SN
Std TRV Body (Polished Chrome)	—	15	2 TRV BOC
Std TRV Body (Brass)	—	15	2 TRV BOB

#### REMOTE THERMOSTAT AND ACCESSORIES

Remote Sensor 2M Capillary	—	—	2 TRV RS Head 2
Remote Sensor 5M Capillary	—	—	2 TRV RS Head 5
Remote Adjuster 2M Capillary	—	—	2 TRV ADJ Head 2
Remote Adjuster 5M Capillary	—	—	2 TRV ADJ Head 5
Std TRV 2-Way Head only	—	—	2 TRV Head
Std TRV Head 'Contract' only	—	—	2 TRV Headcon
Theft resistant Ring	—	—	2 TRV Ring
Theft resistant Collar	—	—	2 TRV Collar
Commissioning Cap	—	—	2 TRV Cap
Close coupled TRV Kit (For LST Radiators)			2 CCKTC
Direct Fit Kit (For LST Radiators)			DIRECT FIT

#### M28 TRV BODY – HEAD ADAPTOR

TRV 2 Way head adaptor (28mm-30mm)	2 TRV Adap
------------------------------------	------------